



Leidos Building 1, Kingsley Office Park
Runcorn Road, Lincoln, Lincolnshire, LN6 3TA

£26,375 pa

Details

- Offices To Let
- 2,110 sqft
- Popular location close to A46 bypass
- The A1 is 20 minutes drive away
- High Specification
- Allocated parking



Location

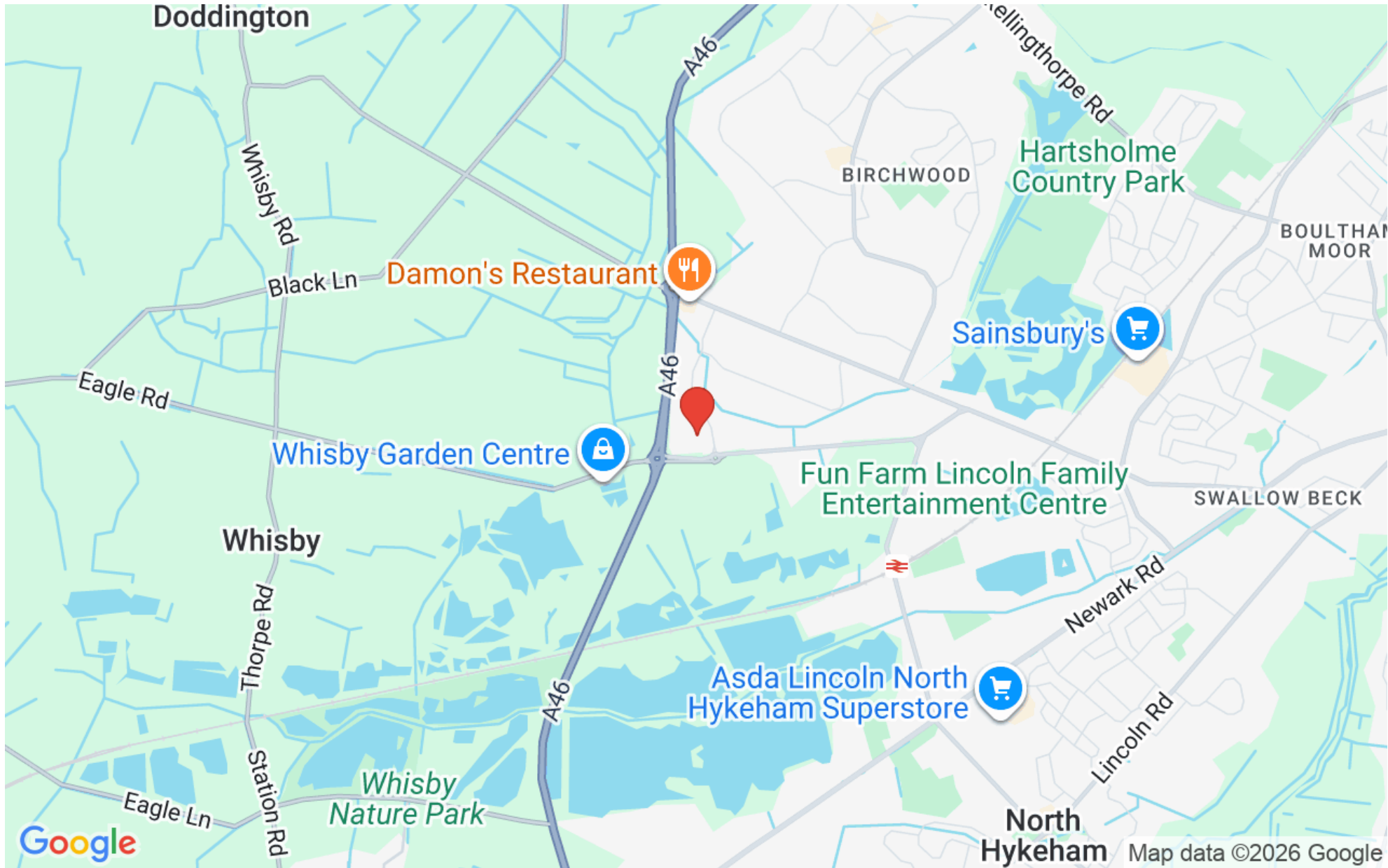

Overview



Kingsley Office Park, Runcorn Road, Lincoln, LN6

Ground Floor Net Internal Area = 2120 sq ft / 196.9 sq m

For identification only - Not to scale

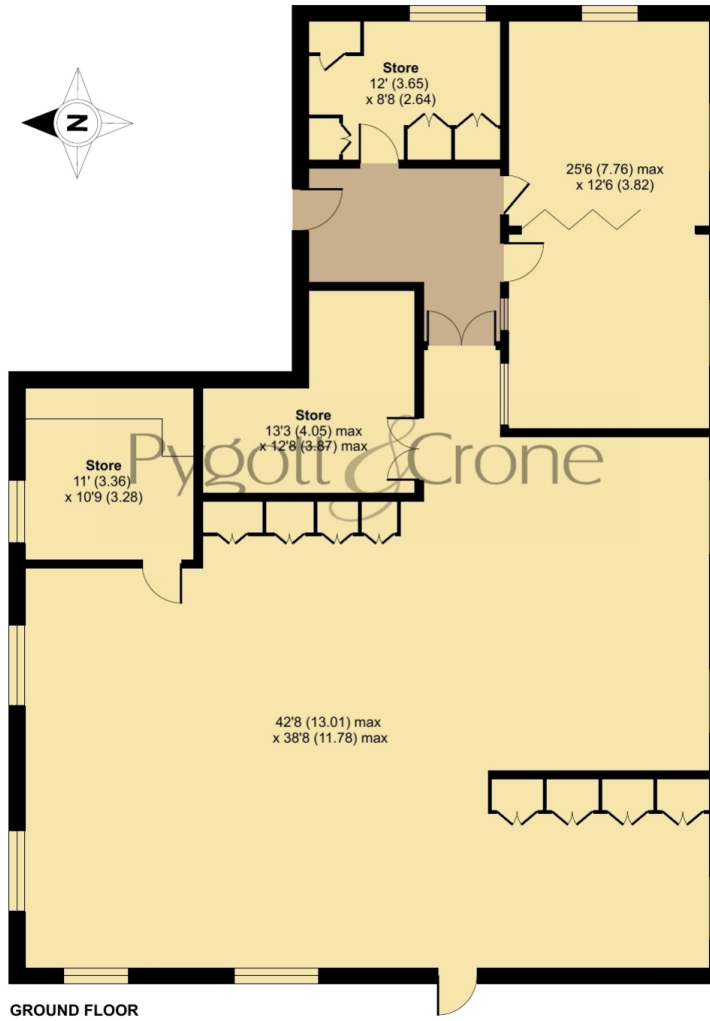

Floor plan produced in accordance with RICS Property Measurement 2nd Edition, Incorporating International Property Measurement Standards (IPMS3 Commercial). © nlcocom 2026. Produced for Pygott & Crone. REF: 1446898





Leidos Building 1, Kingsley Office Park, Runcorn Road, Lincoln, Lincolnshire, LN6 3TA



Leidos Building 1, Kingsley Office Park, Runcorn Road, Lincoln, Lincolnshire, LN6 3TA



Leidos Building 1, Kingsley Office Park, Runcorn Road, Lincoln, Lincolnshire, LN6 3TA



Leidos Building 1, Kingsley Office Park, Runcorn Road
is marketed through our Commercial office

36a Silver Street, Lincoln, LN2 1EW

0330 128 0939